

SITE PLAN

for

"THE GLEN AT SEVEN STONES"

OUTLOT 4 OF SEVEN STONES OF SUSSEX AND OUTLOT 2 OF SEVEN STONES OF LISBON
VILLAGE OF SUSSEX, WI

DEVELOPER:
HCP INVESTMENTS, LLC
2300 N. MAYFAIR ROAD, SUITE 175
WALWATOSA, WI 53226
TEL: (414) 258-4300

ENGINEER:
LOOK ENGINEERING DESIGN GROUP
TRIO ENGINEERING
17700 W. CAPITOL DRIVE
BROOKFIELD, WI 53045
TEL: (262) 790-1480



ISOLATED NATURAL RESOURCE AREA (INRA)
TAKEN FROM WAUKESHA COUNTY
DIGITAL DATA, G.I.S. DEPT.

S.T.H. 164

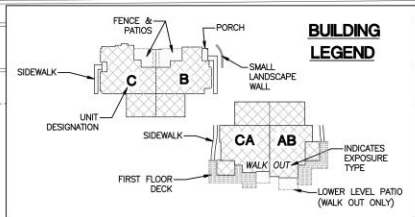

UNIT LEGEND:

- AB = ABBEY
- CA = CANTERBURY
- B = BRAMANTE
- C = COLONNADE

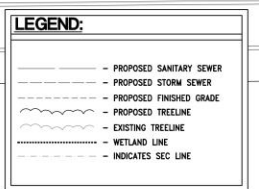

DEVELOPMENT SUMMARY:

- TOTAL AREA: 16.37 Ac.
- DEVELOPABLE AREA: 14.83 Ac.
- INRA AREA: 1.54 Ac.
- NUMBER OF "HOMES": 56
- GROSS DENSITY: 56 UNITS/16.37 Ac. = 3.42 UNITS/AC.
- NET DENSITY: 56 UNITS/14.83 Ac. = 3.77 UNITS/AC.
- % OPEN SPACE: 62%
- EXISTING ZONING: A-1
- PROPOSED ZONING: SF-RD-3 / PDO
- PROPOSED SETBACKS:
 - FRONT SETBACK = 6.5' MIN.
 - REAR SETBACK = 25'
 - BUILDING TO BUILDING SETBACK = 30' MIN.
 - STH 164 & SEVEN STONES DR. SETBACK = 50'

DATE: JUNE 13, 2011